

# SPECIFICATIONS

## Features

- Constant Current Output
- 0-10V Dimming
- Class II Compliance
- Damp Location
- 5 Year Warranty
- Hot Wire Protection
- Supporting DIM TO OFF Capability
- Bottom / Side wire insert

## Mechanical and Thermal

Dimensions	L3.878" x W2.047" x H1.171"
Weight	285 g
Lead Wire Length	Push in connector
Max. Case Operation Temp.	80°C

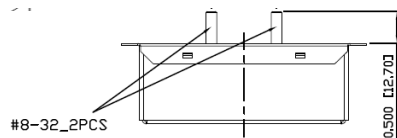

\* Dimension  
in Inch

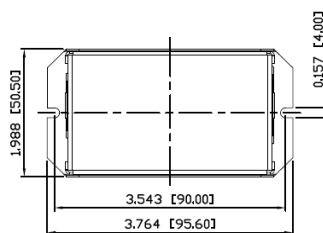

## Wiring Diagram

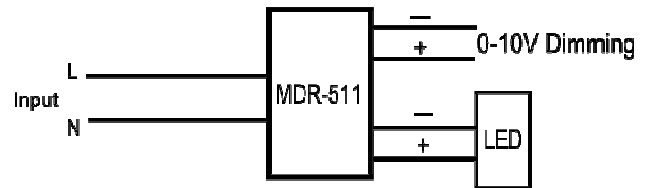

## Protection

- Auto-reset electronic short circuit
- Overload protection
- Inherent Thermal Protection
- Hot Wire Protection

## Environmental Specifications

- Operating Temperature -20° to 60°C
- Storage Temperature -20° to 70°C
- MTBF >100,000 hrs
- Lead Free SMT process
- RoHS compliant

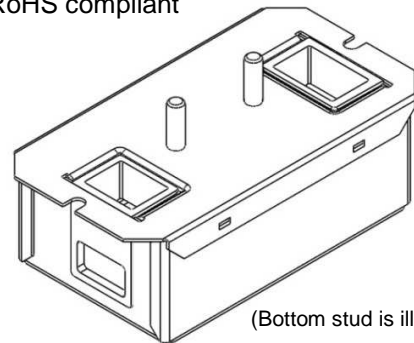

(Bottom stud is illustrated,  
Bottom stud is optional)

## Electrical

Maximum Load	12W
Input Voltage	120 – 277V/50-60Hz
Output Voltage	33-50VDC
Output Current (max.)	220mA
Power Factor	>0.90 (6-12W)
Efficiency @ 80% Load Min	80 typ.
No Load Loss	<1 W

Note –

1. UL file No.: E340781
2. Driver is designated for "Stand by mode" at minimum light intensity (<0.8Vdc) power will not be OFF.



Macron Associate Co. – Power Supply Team

NO.352, Peng-Yi Road, Taiping, Taichung, Taiwan 411

TEL: 886-4-22708357 FAX: 886-4-22767307 Email: macron@macrongroup.com

B1214